

FSU-Microsoft AI Symposium 2026

Brought to you by FSU Research, FSU ITS, Microsoft, Cloudforce, and CDW

cloudforce



FSU-Microsoft AI Symposium 2026

Welcome & Keynote

Stacey Patterson, Ph.D., Vice President for Research

Jonathan Fozard, Associate Vice President and Chief Information Officer

Bobby Sprinkle, Chief Technology Officer

MJ Jabbour, Microsoft Chief Innovation Officer

cloudforce



FSU-Microsoft AI Symposium 2026

Azure 101 Concepts & Applications

Staci Mildenberger, Microsoft Cloud & AI Specialist

cloudforce



Azure as Your Florida Oyster

Azure for Research at Florida State University



Shakespeare Meets Florida

- ‘The world is my oyster’ → opportunity exists, but must be opened
- Florida oysters thrive where fresh meets salt—a living estuary
- Research thrives in dynamic conditions, not perfect ones

The Research Reality

- Time-to-results matters (grants, publications, deadlines)
- Reproducibility & collaboration are now non-negotiable
- Responsibility & trust matter (sensitive data, sponsors)

The Oyster Map

- Estuary — where disciplines meet
- Reef — scalable shared foundation
- Pearl — discoveries & impact
- Shell — protection that enables sharing
- Shucking — how to start

The Estuary

- Interdisciplinary convergence is the norm
- Different data, tools, and collaborators
- Convergence without chaos → shared environment

The Reef

- Elastic compute: scale up, then scale back
- Shared data foundations: less reinvention
- Reusable environments

Reef in Practice

- Deadline week: compute demand spikes
- Cloud burst turns waiting into iterating
- Focus stays on science, not scaffolding

The Pearl

- Collect → Curate → Compute → Communicate
- Repeatable pipelines beat one-off heroics
- Layered iteration turns effort into insight

Pearls in Practice

- Simulations previously constrained by local resources
- Models trained on datasets too large for one machine
- Reproducible environments shared across labs

The Shell

- Protect sensitive data without killing collaboration
- Access controls + auditability + guardrails
- Governance early → fewer late-stage surprises

Shucking the Oyster

- You don't need to become a cloud architect
- Start with one dataset + one bottleneck
- Prove a 30-day 'first bite' pilot

Core Technical Services in Azure

- **Azure Machine Learning** - *Science that stays reproducible*
 - Audit-Ready Research: Automatically tracks code, data versions, and environments for every experiment.
 - Infrastructure-as-Code: Move from a laptop to a 1,000-node cluster with a single command.
 - Eliminate "Sysadmin" Work: Managed environments mean less time fixing Docker and more time analyzing results.
 - Built-in Ethics Tools: Integrated toolkits for model explainability and data privacy compliance.
 - MLflow Native: Real-time experiment tracking without manual spreadsheets.

Core Technical Services in Azure

- **Microsoft AI Foundry** – *One interface for all frontier models*
 - Model Diversity: Single API access to 12,000+ models from OpenAI, Meta, Mistral, and Hugging Face within your secure Azure environment
 - Side-by-Side Comparison: Benchmark different models against your specific research data instantly.
 - Serverless Inference: Pay only for the tokens used; no VM management required.
 - RAG-Ready: Dedicated playgrounds to test models against your own research libraries/PDFs.
 - Future-Proofing: Swap models as new SOTA (State of the Art) versions launch without rewriting your stack.

Core Technical Services in Azure

- **Azure HPC & GPUs** – *Supercomputing performance, cloud flexibility*
 - Slurm Compatible: Use the same job schedulers and MPI libraries you use on-premise.
 - Infiniband Networking: Low-latency interconnects (HB/ND-series) built for tightly coupled simulations.
 - On-Demand H100s: Skip the hardware procurement queue; access high-end NVIDIA GPUs instantly.
 - Hybrid Bursting: Keep baseline workloads local and "burst" to Azure for massive scale or deadlines.
 - High-Velocity Storage: Integrated Lustre support to prevent data bottlenecks during large-scale runs.

Advantages



Use FSU Single-Sign On w/ 2FA



Security compliance standards available



Simplified billing – using ITS AUX PO



Secure connection between FSU Network & Cloud



Microsoft Unified Support is included



Competitive pricing and Enterprise Agreement protections



in myFSU
Service Center

How to Get Started

Who needs
access and
what level?

Azure
Subscription
is created



Sign a Memo
of
Understanding

Create and
submit
internal AUX
PO info

Contact

Breeze Howard

Director, Infrastructure Services
Information Technology Services
Florida State University
bhoward@fsu.edu

FSU-Microsoft AI Symposium 2026

Overview of Azure for Research & Success Stories

Staci Mildenberger, Microsoft Cloud & AI Specialist

cloudforce



Day 1 – Azure for Research Lunch

Thank you to CDW

cloudforce



Day 1 – Azure for Research Hands on Lab

Option A – Build Your Own Models Using Azure Machine Learning

cloudforce



Day 1 – Azure for Research Hands on Lab

Option B – From Concept to Creation
in nebulaONE Agent Workshop

cloudforce



Venue Map

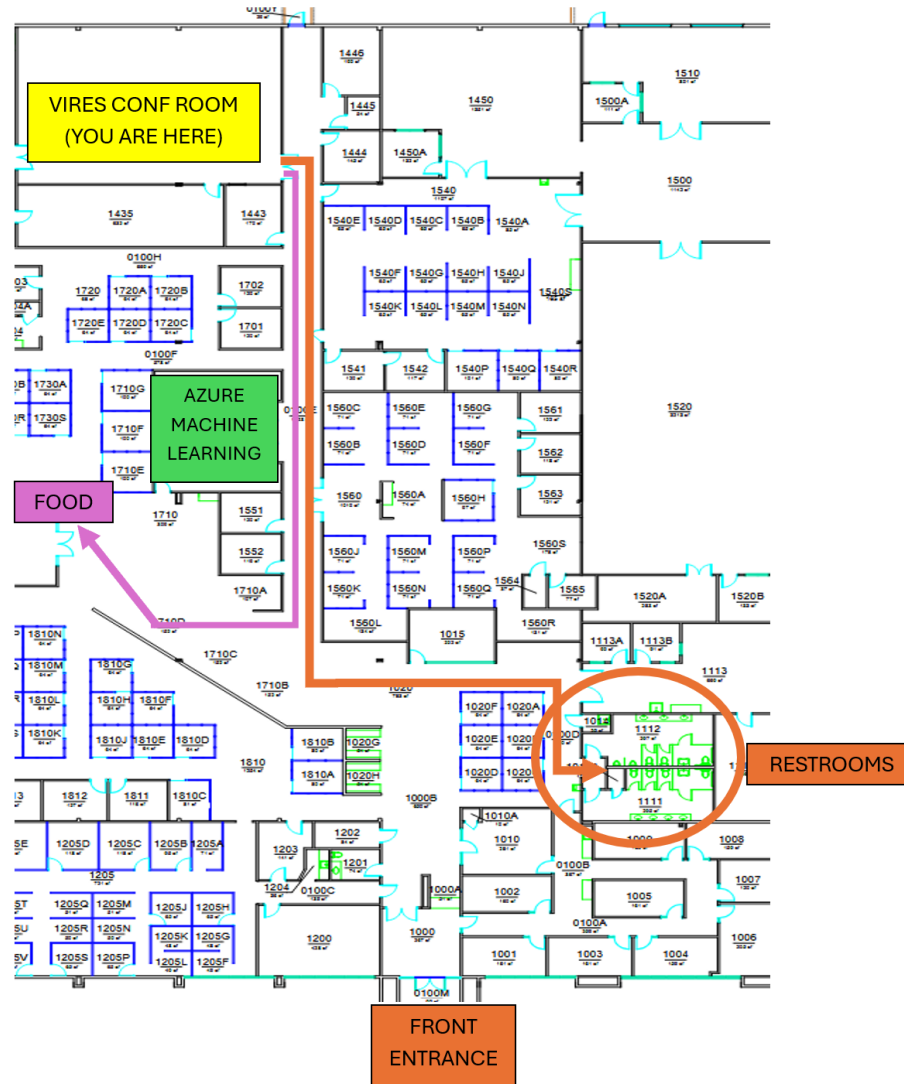

FSU-Microsoft AI Symposium 2026 - Feedback



Venue Map

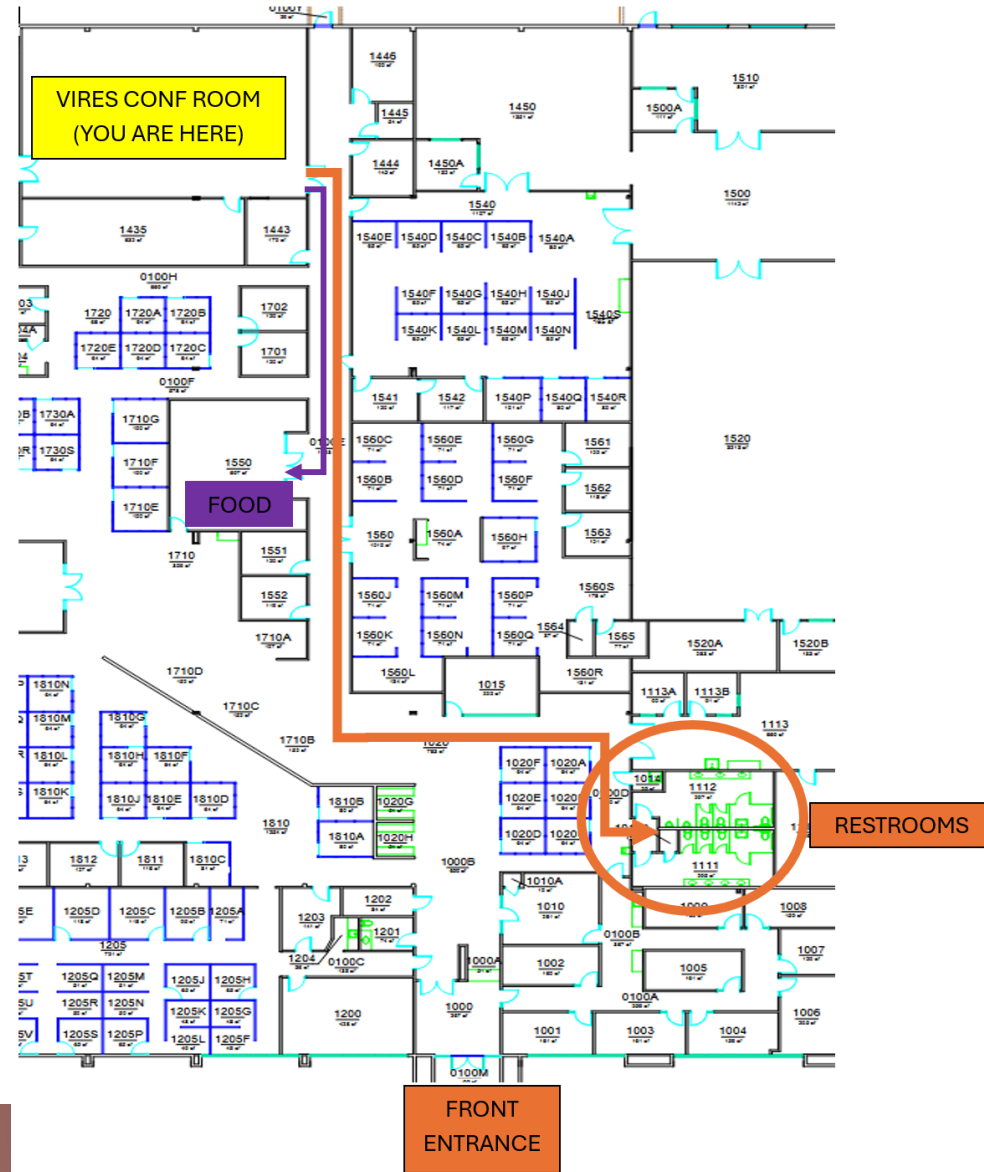

FSU-Microsoft AI Symposium 2026

Welcome to the AI Spectrum

Craig Hogan, AI & Business Solutions Specialist

cloudforce



What is Copilot?

Copilot Product	Primary Purpose	Who Uses It	Data It Uses	Enterprise Data Protections (for FSU data)	What Makes It Distinct	Cost
Microsoft Copilot (Consumer / Windows / Web)	General AI assistance	Individuals	Public web data	No. Do not use FSU data with this product.	Broad, general AI for search, ideas, and explanations; not enterprise-governed	Zero Cost
Microsoft 365 Copilot Chat	Secure AI chat	Microsoft 365 users	Web data (enterprise-protected)	YES	Free, secure AI entry point with enterprise controls; no automatic access to work data	Zero Additional Cost
Microsoft 365 Copilot	Productivity acceleration	Information workers, leaders, faculty	Microsoft Graph (emails, files, meetings, chats)	YES	Embedded in M365 apps; context-aware, permission-based insights and content creation	\$300 Monthly Cost
Copilot Studio	Custom AI & automation	IT, developers, power users	Enterprise + external systems	YES	Build and manage custom agents, workflows, and integrations	Price Varies M365 Copilot Prepay via Credits Azure Sub

Copilot.Microsoft.com

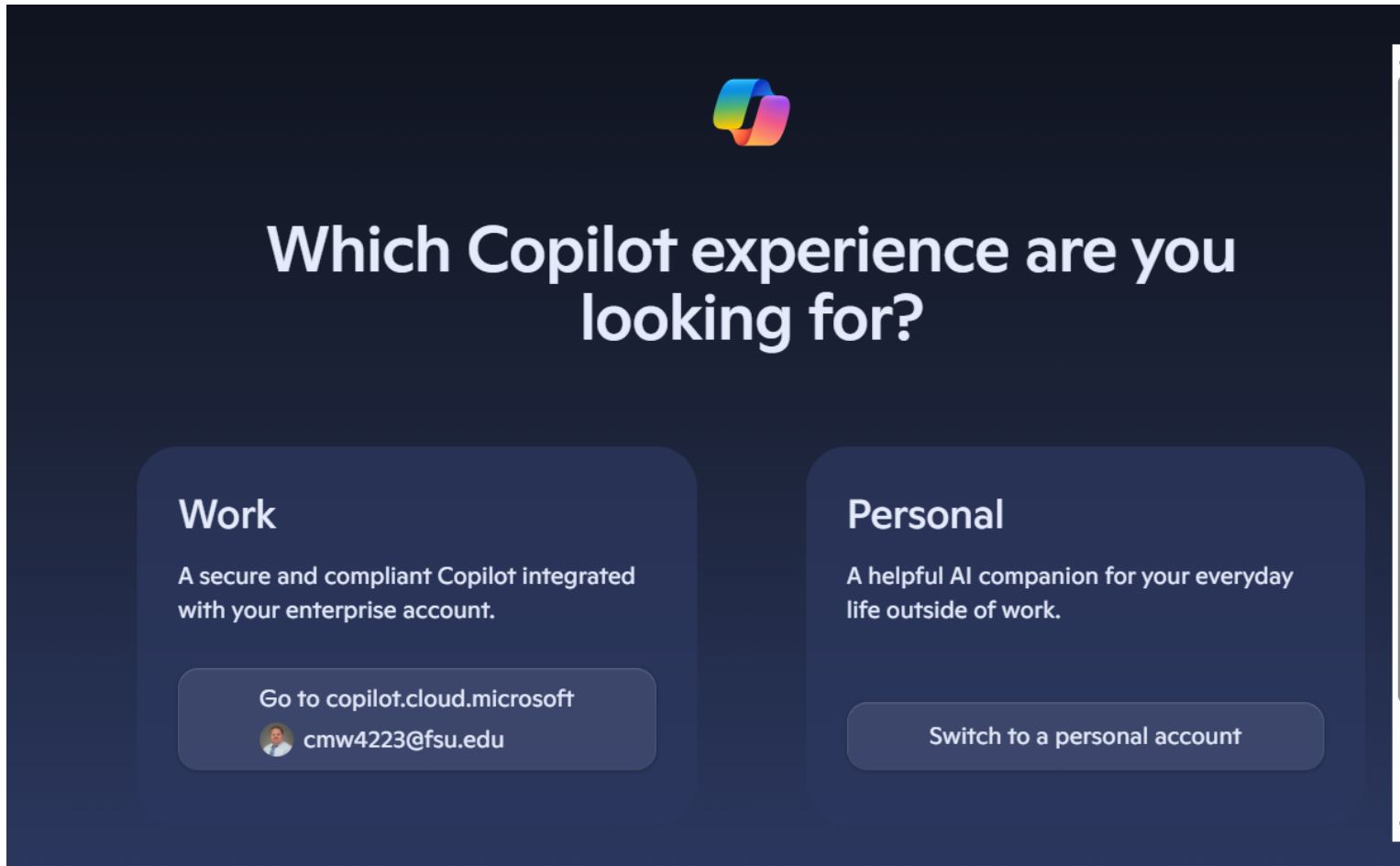

The screenshot shows the Copilot Microsoft website interface. At the top center is the Copilot logo, a colorful knot-like shape. Below it, the main heading asks "Which Copilot experience are you looking for?". There are two main options presented in dark blue rounded rectangles:

- Work:** A secure and compliant Copilot integrated with your enterprise account. Below this is a button that says "Go to copilot.cloud.microsoft" with a user profile icon and the email address "cmw4223@fsu.edu".
- Personal:** A helpful AI companion for your everyday life outside of work. Below this is a button that says "Switch to a personal account".

Microsoft 365 Copilot Chat Basic Vs. Premium

<https://m365.cloud.microsoft/chat>

• Basic

• Premium

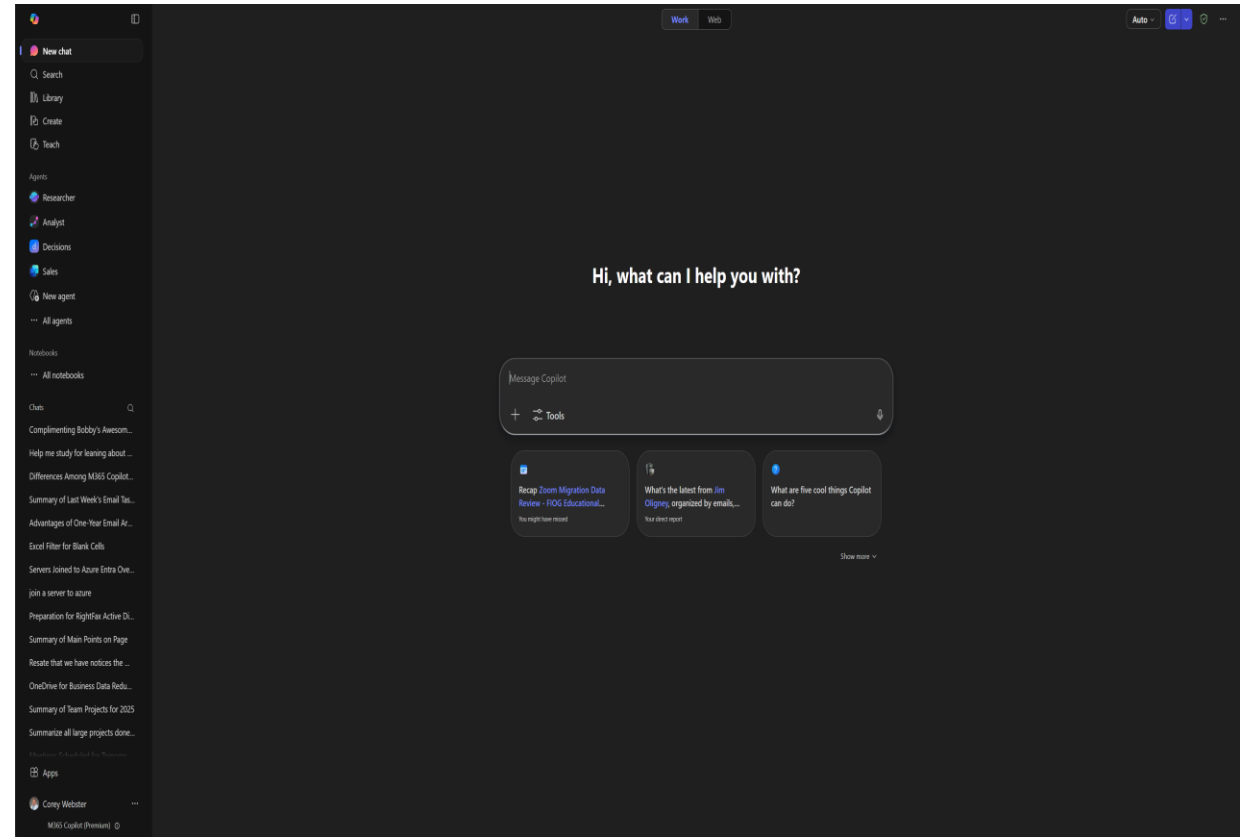
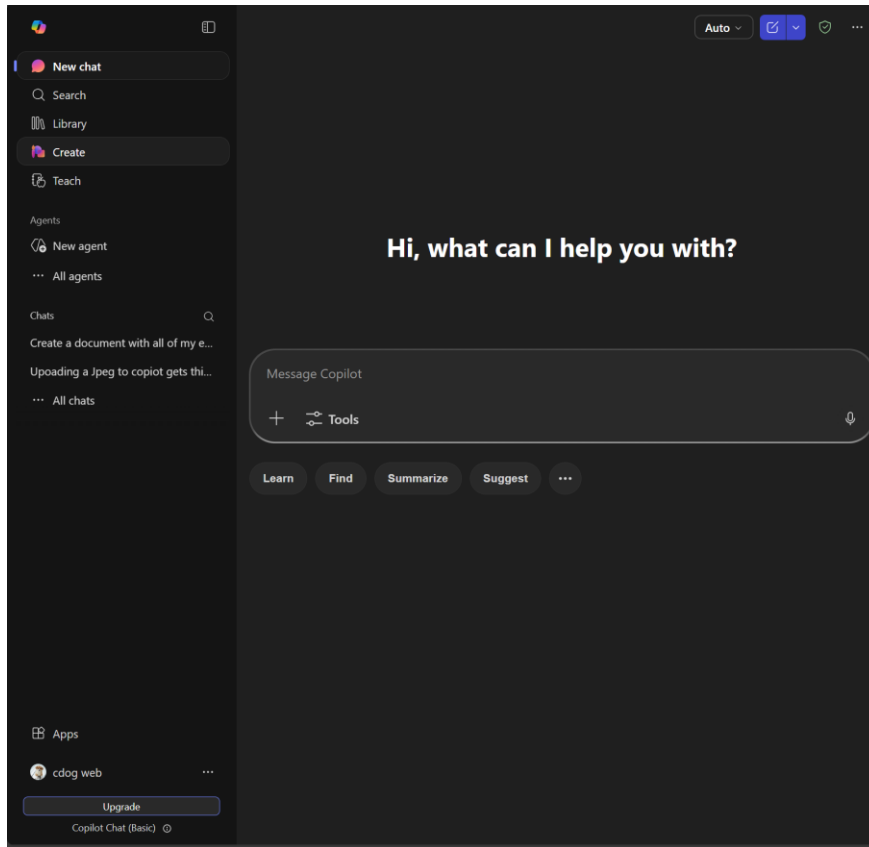

Microsoft 365 Copilot Chat

Basic Vs. Premium

<https://m365.cloud.microsoft/chat>

- Basic

- Premium

Looks for the green check.

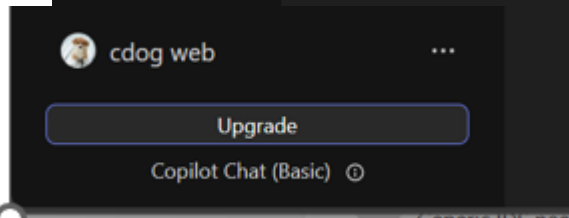
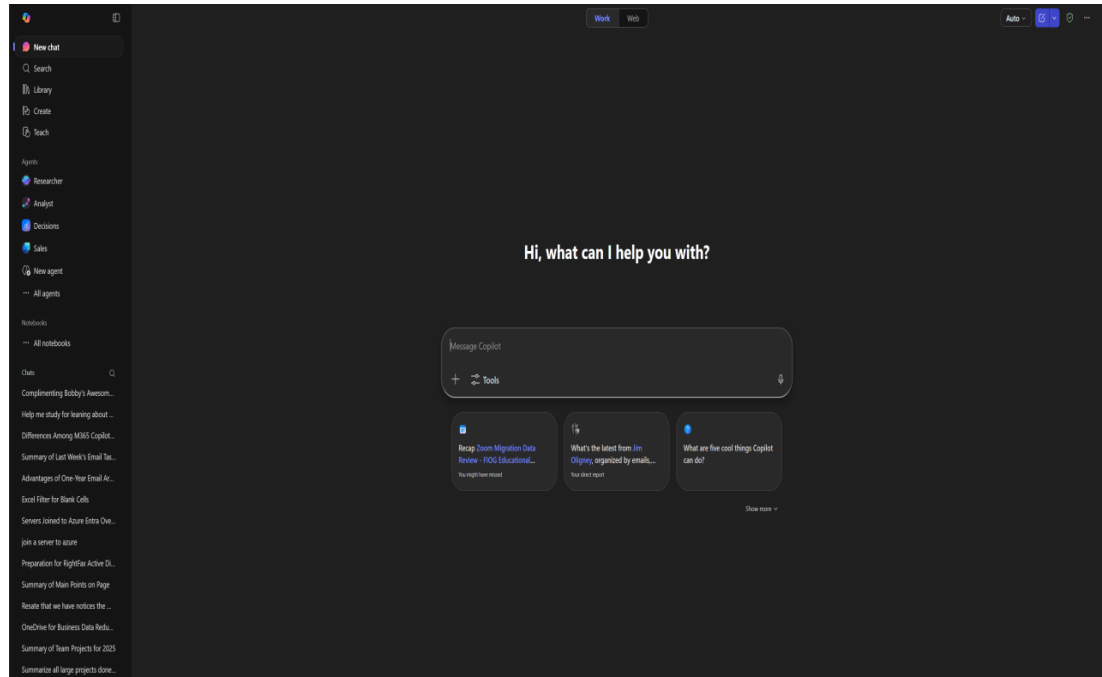
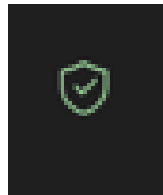
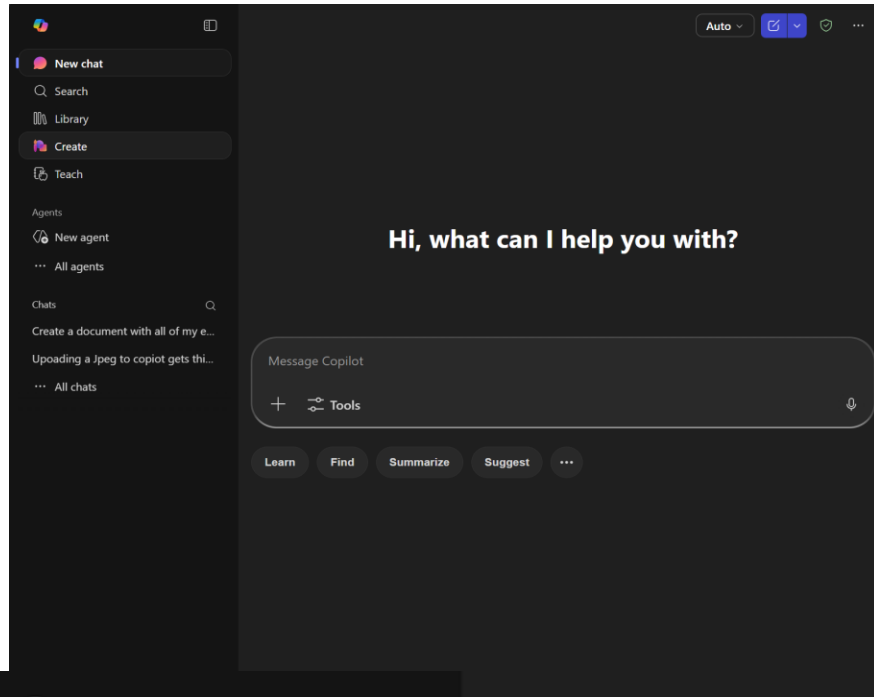

Check out the different license.

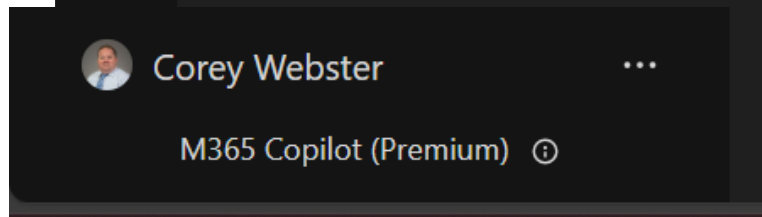

Why M365 Copilot?

The Challenge

Our staff and leaders spend significant time reading, drafting, summarizing, and synthesizing information instead of acting on it.

The Shift

Microsoft 365 Copilot embeds AI directly into Outlook, Teams, Word, Excel, and PowerPoint—turning everyday work into faster, insight-driven work.

The Value

- **Faster decisions:** Immediate summaries, insights, and action items
- **Productivity at scale:** Less time on routine work, more time on mission
- **Secure by design:** Uses existing permissions, compliance, and governance

The Outcome

Reduced administrative friction—more capacity for teaching, research, service, and strategy.

<https://copilotstudio.microsoft.com/>

Florida State University Copilot Studio

Home Agents Flows Tools

What would you like to build?

Agent Workflow

Start building by describing what your agent needs to do

Start building from scratch

Help

- [Documentation](#)
- [Free Workshop: Agent in a Day Training](#)
- [Support community](#)
- [Idea forum](#)
- [Blog](#)
- [Release plans](#)
- [See what's new](#)
- [Learn more about responsible AI at Microsoft](#)
- [Send feedback](#)

Legal | [Privacy & cookies](#)
Your Privacy Choices

<https://go.microsoft.com/fwlink/?linkid=2191990>

Procure Microsoft Copilot Office 365 M365Copilot

- \$300 Per User Per Year
- Open a ticket with the following
 - I would like M365 Copilot license
 - FSUID
 - Internal PO # to give ITS Software Licensing
- Questions Contact ITS-Software Licensing Or Corey Webster
Cmwebster@fsu.edu

How to get started with Copilot Studio

- Open a case
- Provide security group
- Provide a variable environment name that you want deploy agents in
- Case Example

I would like a new PowerPlatform environment for my department of Biology called Bio-Xvariable. Please use the existing security group called SG-BIO-Xvariable to grant access and license the users.

Contact

Corey Webster

Associate Director Collaborations Services

Information Technology Services

Florida State University

cmwebster@fsu.edu

Lunch & Networking

Thank you CDW!

cloudforce



FSU-Microsoft AI Symposium 2026 - Feedback

